



Acoustic Wood Baffles



Real wood, superior acoustic core, flexible installation options, priced right. Mode Acoustic throws the old “high quality, lower cost, done quickly — pick “two” maxim right out the window. Wood in spaces adds a warmth that discerning modern design sometimes lacks. Mode Acoustic Wood Baffles lets designers leave tired skeuomorphic solutions in the past where they belong.

Specifications

Product Name	Mode Acoustic Wood Baffles
Lead Time	–10 weeks
Content	–Premium wood veneer and an acoustical core with 56% recycled content
Thickness	–2.5” (nominal)
Length	–4’, 6’, 8’ (Custom lengths available)
Height	–6”, 8”, 12” (Custom heights available)
Tolerance	–1/16”
Weight	–3.4lbs per sq. ft.
Sound Performance	–ASTM C423-17 NRC: 1.12
Fire Performance	–Class A materials
Variations	–Slight and consistent variations in color and woodgrain should be expected when using this material. Slight imperfections are within normal manufacturing tolerances and not visible in standard installations.
Environmental	Panels consume a quarter of the natural resources and have a dramatically lower carbon footprint compared to equivalent millwork.
Maintenance	Vacuum to remove any loose dirt or dust. A damp cloth or compressed air can also be used to dust the material in difficult or large installations. If stains are present, you may saturate a lint-free cloth with a soap and water solution or Murphy’s Oil soap.
Warranty	5 years
Unit of Sale	Per carton: 4

Hardware & LED Lighting

Cable Gripper

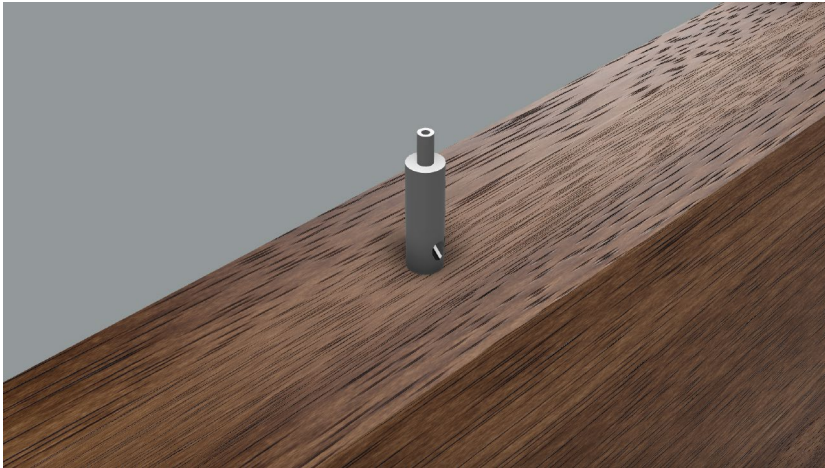

- Side cable-exit Gripper
- 1/4-20 external thread
- For use with 1/16" aircraft wire
- Standard release
- Color: silver
- Hardware installed on 24" or 48" oc for standard sizes
- Installer responsible for aircraft wire and ceiling-side mounts (Mode can supply on request)

LED Lighting

- Continuous lighting strips — hotspot-free appearance (even in low profile channels)
- Correlated color temperature (CCT): 3,000K (warm white)
- Fully dimmable (dimmer sold separately)
- UL Listed and RoHS
- 90 watts per reel | 18 watts per meter
~6 watts per foot 7350 lumens per reel
1470 lumens per meter
- Power supply varies by application (sold separately). We generally recommend using a power supply rated for at least 20% higher wattage than the lighting. We recommend and can supply Meanwell products. Keeping drivers close to lighting helps prevent voltage drop issues.
- Baffle suspension has integrated low-voltage wire - length from baffle to ceiling required at time of order.

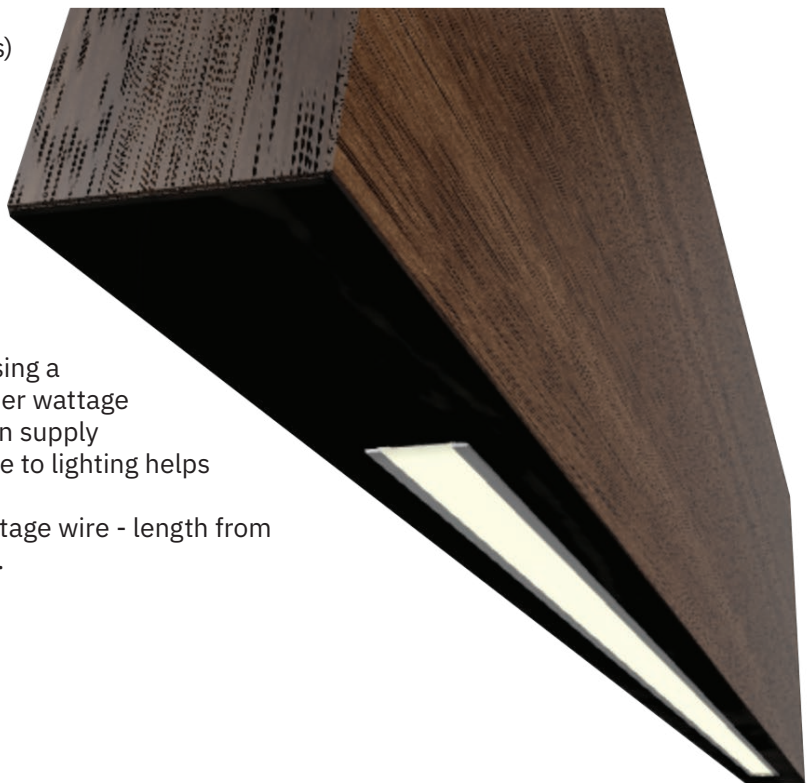

Color & Finishes



One in a Million

Mode Acoustic offers over one hundred veneers, custom staining, and sequencing to meet the needs of any project.



Test Results

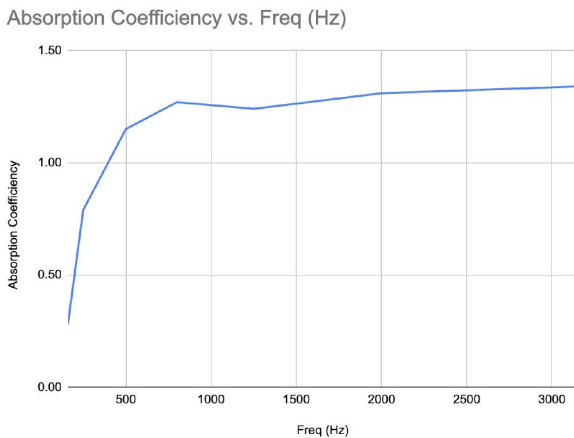

Freq (Hz)	Absorption Coefficient
160	0.28
250	0.79
500	1.15
800	1.27
1250	1.24
2000	1.31
3150	1.34
NRC	1.12

The Noise Reduction Coefficient (NRC) is calculated as the arithmetic average of the absorption coefficients in the shaded bands only (250, 500, 1250 & 2000 Hz).

ASTM C 423-17: Type J Mounting — using 10 baffle units suspended with aircraft wire. 12" oc to simulate a typical baffle installation.